



Beltone™
hearing aids

Quick guide to the Beltone HearPlus™ app for Android



 **Beltone™**

Introduction to Beltone™ hearing aids

Which Beltone hearing aids work with the Beltone HearPlus app?

Your hearing aids must be running the latest firmware to be compatible with the Beltone HearPlus app. If not, your dispenser can help you update it.

Beltone hearing aids



Beltone First™



Beltone Boost™

Android devices that work with Beltone hearing aids

The HearPlus app is compatible with one of the most popular Android phones, the Samsung Galaxy S5 running Android 4.4.2–4.4.4 'KitKat'.

Over time we expect the list of compatible Android phones to grow, so we are maintaining a list of compatible devices at the Beltone HearPlus app webpage.

For this and other up-to-date information visit beltone-hearing.com/hearplus



Samsung Galaxy S5

Smart control and personalization with the Beltone HearPlus™ app

The Beltone HearPlus app puts basic controls and more advanced features at your fingertips so you can personalize your hearing experience.

The Beltone HearPlus app is the first hearing aid app with a direct connection between your hearing aids and Android phone.

What can the Beltone Hear Plus™ app do?

You can use the Beltone HearPlus app to:

- Adjust volume settings on your hearing aids
- Change programs
- Rename programs
- Adjust bass and treble
- Save a program and settings to favorite places
- See battery and connection status
- Get inspiration and personalized information about your hearing aids
- Help locate lost or mislaid hearing aids

Where can I find the Beltone HearPlus™ app?



- You can download the Beltone HearPlus app for free from the Google Play Store.
- Go to Play Store on your Android phone and search for **Beltone** and **HearPlus**
- Tap on **Install**, then **Accept** so the app can access certain features on your phone such as Bluetooth
- Your phone will now install the app
- When installation is complete, tap on **Open** to start up your ReSound Smart app

For more information, please visit beltone-hearing.com/hearplus

Pair with your Android phone

How to pair your Beltone hearing aid to your Android phone

Insert a fresh battery in your Beltone hearing aid.
Keep the battery door open so the hearing aid cannot power up.

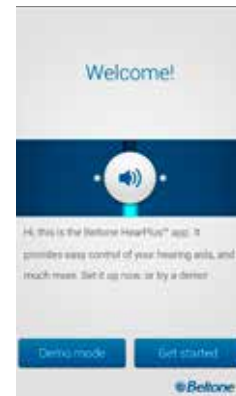

Open the Beltone HearPlus app on your phone.

You can start the pairing right away. If you would like to watch a demonstration of the app, press **Demo mode**.



Check that your hearing aids are in the list of compatible products. Press **OK**.

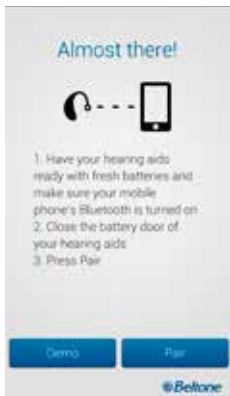

Close the battery door of the hearing aids and press pair.

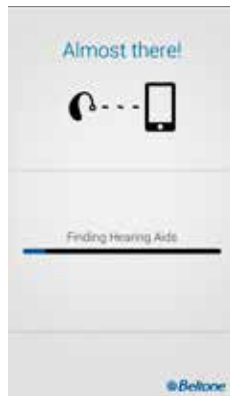

The app will search for nearby hearing aids.



Select your hearing aids and press the Connect button. If no hearing aids are found, you can try searching for hearing aids again by pressing Search.

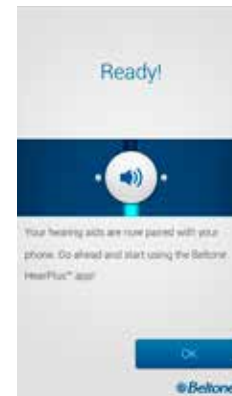

The phone will now connect to your hearing aids, and you are ready to use the app.

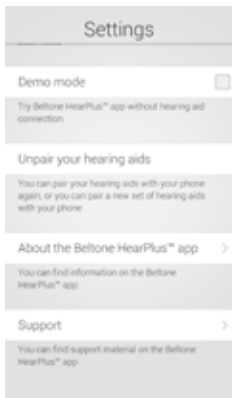

Unpairing your hearing aids
Follow these steps if you want to unpair your hearing aids so you can pair to different Beltone hearing aids, for example.

Go to the app Settings and select **Unpair your hearing aids**. Tap on Unpair in the pop-up notification and the hearing aids will be unpaired.

How to re-connect your hearing aids to your Android phone

When your hearing aids are out of range, or you turn them or your Android phone off, they will no longer be connected. When the hearing aids come into range again, or you turn them or your phone back on, they will take a few seconds to automatically reconnect.

TIP WANT TO ACTIVATE UNPAIRED HEARING AIDS?

Once a hearing aid is forgotten, you will need to follow the steps on page 5 it with your hearing aids again.

Beltone HearPlus™ app overview

The app has two main pages: Volume control and Program selection. You can simply slide from one screen to the other, or use the navigation buttons. There is also a main menu button which gives you access to additional app functions.



Program selection



Tap this button when you are on the Programs page to return to the Volume control page.



Tap the More options button to open a window which gives you access to advanced functions.



Volume control



Tap this to go to the Programs page.



Tap this to go to the main menu page for extra functions.

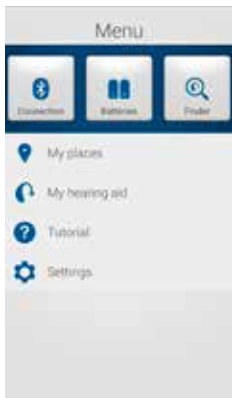

Main menu for extra functions



Additional app function include:
 Connection status
 Battery status
 Finder
 My places
 My hearing aid
 App tutorial and settings



You can use your phone's back hard key to go back to the previous page.

Adjust volume settings



Combined volume control



Slide the volume slider up to raise and down to lower the volume of the hearing aids.



Tap the mute button beneath the volume slider to mute the hearing aids, and tap again to unmute.



Independent volume control



Use the pinch gesture to switch between combined and independent hearing aid volume control.



Or tap the toggle button at the bottom of the page.

Streamer volume control



Streamer device volume



When a streamer device program is selected, you can adjust the streaming volume separately with the green volume slider.

Hearing aid volume



You can still mute or adjust the volume of the hearing aids without affecting the volume of the audio you are streaming.



Independent volume control



You can adjust the volume of left and right hearing aids independently. Switch between combined and independent volume control with the pinch gesture or tap the toggle button at the bottom of the page.

TIP HOW DO I RESET THE VOLUME?

To reset the volume to its default position, align the slider with the white dots.

CHANGE PROGRAMS



Manual program change



Tap the buttons to choose one of up to four different hearing aid programs that have been optimized for particular hearing situations. Each program has its own icon to help you choose.



Streaming device change



Tap a streaming device button to activate streaming from a Beltone Direct™ device such as a Beltone Direct TV Link 2.

Adjust bass and treble

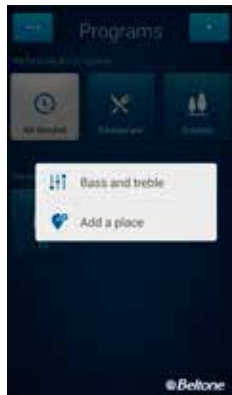

More options



The blue More options button at the top left opens a pop-up menu with options that give your clients more advanced control and personalization of their hearing experience.

The bass and treble option



You can adjust the bass and treble of all incoming sound.

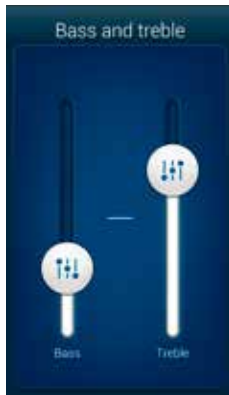

Adjusting bass and treble



Add or cut bass and treble from sounds by moving the sliders up or down.

TIP CAN I SAVE MY SETTINGS?

When you find bass and treble settings you like, you can save them and associate them with a certain place. If you would like these settings applied to your general hearing-aid setup, simply show them to your hearing care professional.

My places

You can save your preferred settings to a place. This means that you can save your favorite program, bass and treble, and volume settings so they activate every time you return to that place.

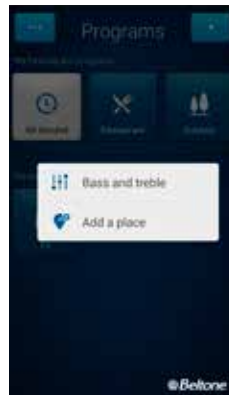

Add a place

You can save your preferred volume, bass and treble settings by adding a place. You can choose to have the settings activate automatically or to receive a prompt when you go back to that place.



Overview of places

On the My Places page you can also add a place with a new set of settings by pressing the + button.

And, you can also switch between list view and map view.

TIP CAN I SAVE SETTINGS FOR CERTAIN LISTENING SITUATIONS?

You can use Places to create your preferred settings for certain listening situations. For example, you can save settings for noisy traffic, so whenever you find yourself in noisy traffic you can activate that profile by tapping Use now.



Additional my places options

By swiping left on a place you are able to:

- Remove the place
- Rename the place

Tap a place or Map in My places to view the place on a map.



Map view of my place

In map view you are able to:

- Get an overview of all your saved places
- See details of each place such as the address and the last time you were there
- Activate a place's settings from anywhere you like by pressing Use now.

TIP CAN I EDIT MY PLACES WITHOUT LOSING MY SETTINGS?

If you select a place and adjust settings such as the volume or bass and treble, you can save your changes as a new place so you don't overwrite the original.

Finder: Search for mislaid hearing aids

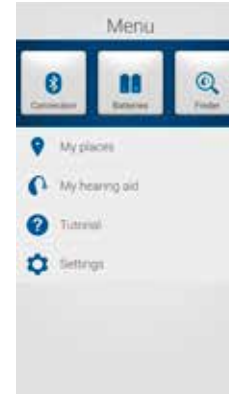

Finder

Use the Finder to search for mislaid hearing aids.

Nearby search

If the app detects the hearing aids nearby, it will go into Nearby mode. As you walk around the light blue bars will show you if you are getting closer or farther away from your hearing aids.

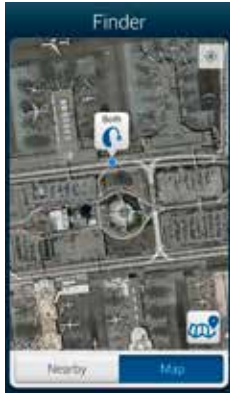

Distance search

If the app does not detect the hearing aids nearby, it will switch to Map view and display the place on the map where they were last detected.

Last location

Tap the callout to see the address and time the hearing aids were last detected.

Additional app options



My hearing aid

This section will provide inspiration and information about your Beltone hearing aids.

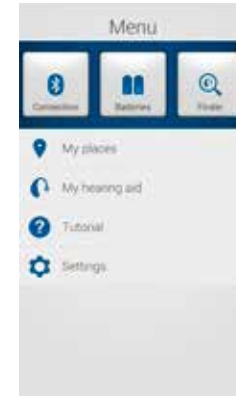

Battery status



This shows the current status of left and right hearing-aid batteries. The icons display the batteries as full, less than full or very low.



The icon displays the battery strength as full in the left hearing aid and very low in the right one.

Connection status

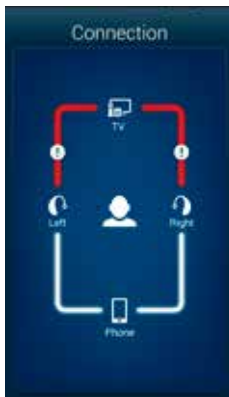

Check your connections

Shows the connection status between your hearing aids, streamer device and Android device.

The red line with an exclamation mark means the connection is missing or broken.

TIP WHAT IF I LOSE A CONNECTION?

When a connection is lost, press the exclamation mark to receive guidance on how to re-establish the connection. It is a good idea to check that your hearing aids are powered on, are within phone range and have enough battery charge. You can also open and close the battery door if connection is not re-established straight away.

App settings

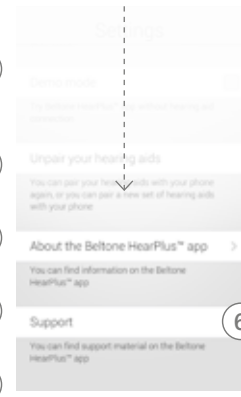
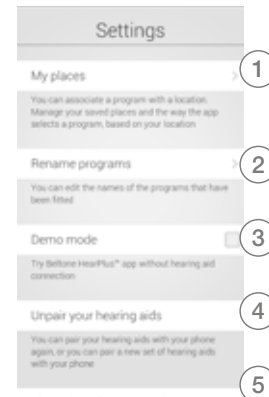

Settings

The app settings enable adjustments to specific features of the Beltone HearPlus™ app.

1. Remove all Places at once
2. Rename programs
3. Demo mode
4. Unpair your hearing aids
5. Background information about the Beltone HearPlus app
6. Guide to support material

Stream sound to your Beltone HearPlus™ hearing aids

Stream from your Android phone to your Beltone hearing aids using the Beltone Direct Phone Link 2

When paired and connected to the Beltone Direct Phone Link 2, your Beltone hearing aids can stream stereo sound from your Android phone.

Simply open a media player on your phone and press play. Your hearing aids will switch to the streaming program and after a few seconds you will hear audio.

Pairing your Beltone Direct Phone Link 2 with your Android phone

- Go to the phone settings and make sure that Bluetooth is turned on
- Turn on the Phone Link 2, remove the silver cap, and locate the small blue Bluetooth pairing button
- Tap the button once to activate Bluetooth pairing mode. The LED indicator will turn blue and the Phone Link 2 will be in Bluetooth pairing mode for 2 minutes
- After a few seconds, select **Hearing Aid Phone** from the list of available Bluetooth devices on your phone
- If asked for a passcode, enter 0000 (four zeros) and then select **Headset**

Pairing your Beltone Direct Phone Link 2 to your hearing aids

- Open the hearing-aid battery door
- Turn on the Phone Link 2, remove the silver cap, and locate the small white hearing aid pairing button
- Tap the button to activate the hearing aid pairing mode. The LED will blink yellow every 2 seconds and the Phone Link 2 will be in pairing mode for 20 seconds
- Close the battery doors on your hearing aids

For further information about the Beltone Direct Phone Link 2 refer to the user guide, instruction video or visit beltone-hearing.com/products/wireless-accessories

Try more apps from Beltone

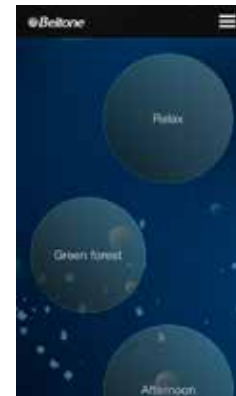

Beltone Tinnitus Calmer™



If you suffer from tinnitus, you might like to try the Beltone Tinnitus Calmer™ app.*

It combines relaxing sounds and exercises that aim to help you find relief from tinnitus.

beltone-hearing.com/tinnitus-calmer



Beltone SmartRemote™



If your hearing aids and/or smart phone is not compatible with the Beltone HearPlus™ app, use the Beltone SmartRemote app* with Beltone wireless hearing aids and a Beltone Direct Phone Link 2.

beltone-hearing.com/smartremote



*Dependent on local availability

Beltone. Helping the world hear better

Beltone was founded on the act of helping a friend to enjoy life more. Since 1940, we have provided knowledge, tools, service and training to the professionals servicing the hearing impaired. Beltone makes quality hearing care available to more people. To do so, we develop technically optimal hearing solutions without ever losing focus on the individual's needs. It is our belief that no individual should be denied the possibility of an improved life with better hearing.

For more information and support for the Beltone HearPlus™ app see the Android app user guide or visit beltone-hearing.com/hearplus

Android and Google Play are trademarks of Google Inc. The Android version of the Beltone HearPlus app runs on selected Android devices. See www.beltone-hearing.com/hearplus for a list of Android phones that work with the app.

WORLDWIDE HEADQUARTERS

Beltone A/S
Lautrupbjerg 7
DK-2750 Ballerup
Denmark
Tel.: + 45 45 75 11 11
Fax: + 45 45 75 11 19
Web: www.beltone-hearing.com

